Ambient Weather EZ-HD-PTP-100 Heavy Duty Mast to Mast Mounting Kit for AcuRite® Weather Stations User Manual



Table of Contents

1.	Introduction.....	1
2.	Accessories	1
3.	Parts.....	2
4.	Warnings	2
5.	Recommended Tools and Materials	2
6.	Mounting Installation.....	2
7.	Optional Mast Extension.....	4
8.	Warranty Information.....	5

Trademark Notice: Ambient Weather (Ambient, LLC) is not in any way associated with AcuRite®. AcuRite® is a registered trademark of Combex, Inc.

Product names, logos, brands, and other trademarks featured or referred to within Ambient Weather products are the property of their respective trademark holders. These trademark holders are not affiliated with Ambient, LLC, our products, or our website. They do not sponsor or endorse our products in any way.

1. Introduction

The EZ-HD-PTP-100 mounting kit allows you to connect your weather station to another pole that is between 1 and 2” diameter. Two sets of clamps are added for stability, as well as a mounting pole for connecting to your weather station with pre-drilled holes.

The Ambient Weather 1" OD pole mounting kit is constructed of rust proof 10-steel tubing, galvanized using the Flo-Coat (zinc-chromate ploymer) for excellent corrosion proof protection.

Includes one 35" 1.00"-diameter smooth mast. Add a mast extension (Figure 1) to extend the pole an additional 31" per extension.

2. Accessories

Item Number	Description
EZ-100-35M	Mast Extension. Add up to two mast extensions to extend the height of 31" per mast extension.

Figure 1

3. Parts

Qty	Description
1	35" 1.00"-diameter smooth mast
2	8" x 5/16" Threaded Rods
8	Pole Mounting Brackets
16	5/16" dia - 7/16" Keps Nuts
3	#2 Phillips set screws for weather station mounting. Includes one spare.

Figure 2

4. Warnings

 **WARNING:** Improper installation of the mounting kit to your home or building may result in leaks. We recommend a licensed roofing specialist for invasive installations.

 **WARNING:** Any metal object may attract a lightning strike, including your weather station and mount. Never install your weather station in a thunderstorm.

 **WARNING:** We recommend properly grounding the mount to avoid extensive damage to the weather station and structure. Consult a licensed electrician or local lightning detection expert prior to installing a ground wire.

 **WARNING:** Installing your weather station in a high location may result in injury or death.

5. Recommended Tools and Materials

- Phillips Precision screwdriver Size: #2 Phillips.
- 7/16" wrench
- Level or Plumb

6. Mounting Installation

1. Reference Figure 3. Assemble both mounting brackets, lock nuts, threaded rods and nuts.

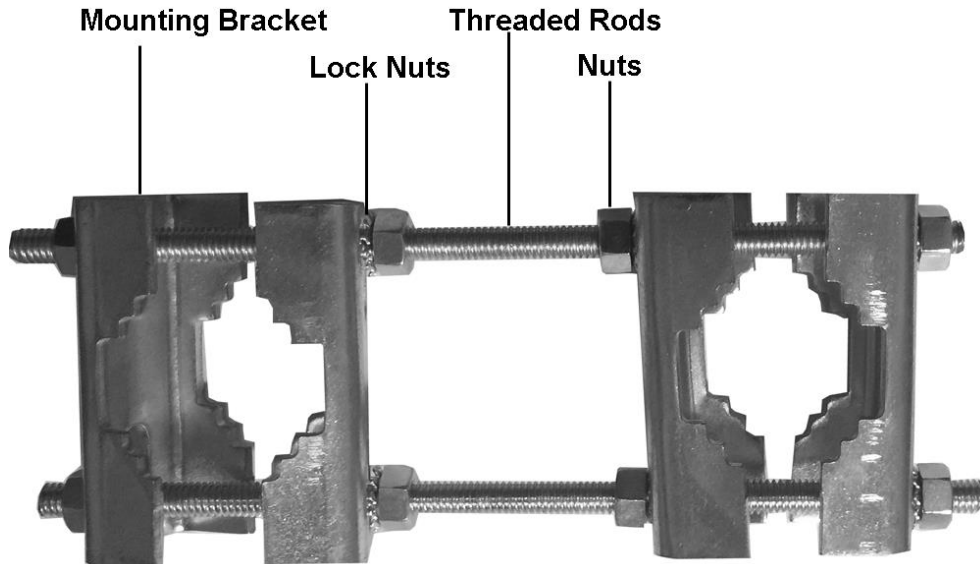

Figure 3

2. Reference Figure 4. Insert the weather station mast (included) and your mounting mast (not included) and tighten both brackets securely around the poles.

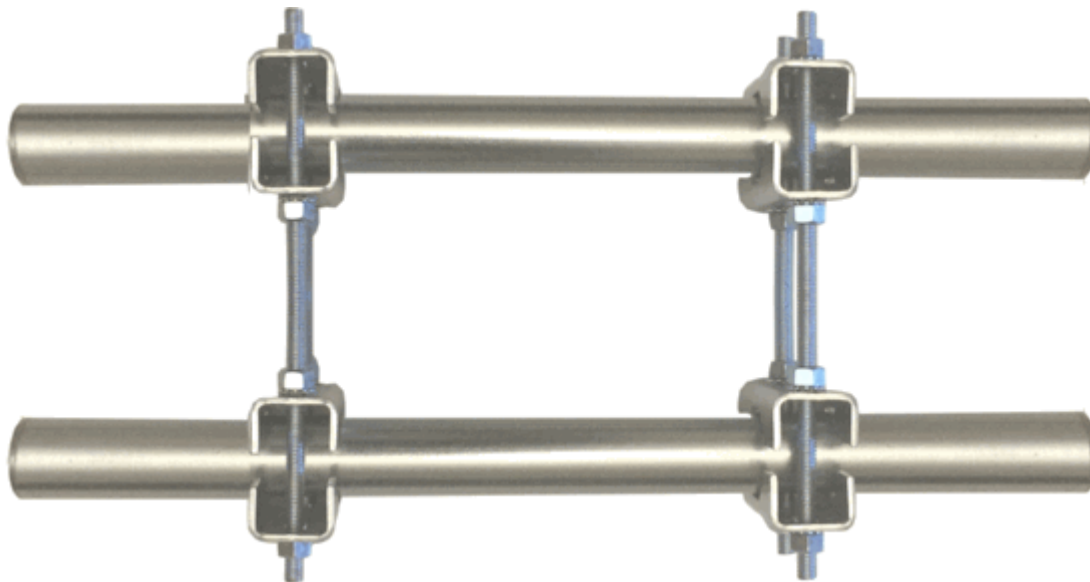



Figure 4

3. Reference Figure 5. If your weather station includes guide screws (AcuRite®), locate the screw holes on the mounting mast, and (a) draw a line with a permanent marker or Sharpie to align the holes. Insert the screws (b) into the plastic housing. Do not completely tighten screws until both screws are inserted to make sure they are properly aligned.

 **Note:** It is possible to strip the screws if the proper sized screwdriver head is not used. A spare screw is included with this kit.

We suggest the use of a cordless drill. Always use safety glasses and safety gloves when operating a

cordless drill.

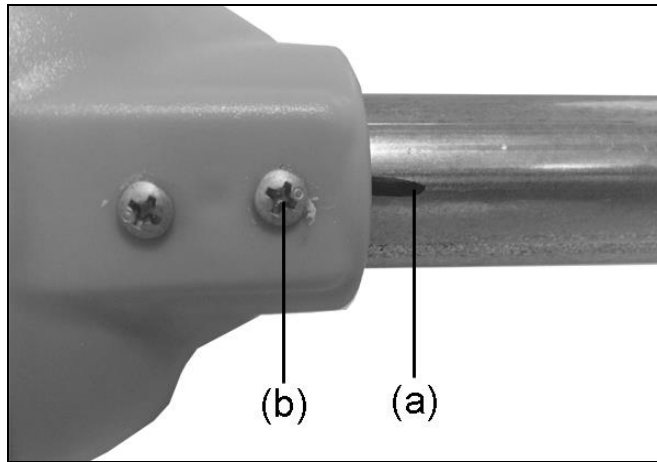

Figure 5

4. Reference Figure 6. Mount the weather station and mast to mast brackets vertically. Make certain the weather station is plumb and level.



Figure 6

7. Optional Mast Extension

An optional mast extension (Item No. EZ-100-35M) allows you to extend your mounting mast by 31”.



Figure 7

Insert the swaged end of the mast extension into the mounting tripod mast and tighten so the extension does not rotate, as shown in Figure 8.

Repeat this step for additional mast extensions (maximum two is recommended).



Figure 8

8. Warranty Information

Ambient, LLC provides a 1-year limited warranty on this product against manufacturing defects in materials and workmanship.

This limited warranty begins on the original date of purchase, is valid only on products purchased and only to the original purchaser of this product. To receive warranty service, the purchaser must contact Ambient, LLC for problem determination and service procedures.

Warranty service can only be performed by a Ambient, LLC. The original dated bill of sale must be presented upon request as proof of purchase to Ambient, LLC.

Your Ambient, LLC warranty covers all defects in material and workmanship with the following specified exceptions: (1) damage caused by accident, unreasonable use or neglect (lack of reasonable and necessary maintenance); (3) damage resulting from failure to follow instructions contained in your owner's manual; (4) damage resulting from the performance of repairs or alterations by someone other than an authorized Ambient, LLC authorized service center; (5) units used for other than personal use (6) applications and uses that this product was not intended (7) the products inability to receive a signal due to any source of interference or metal obstructions and (8) extreme acts of nature, such as lightning strikes or floods.

This warranty covers only actual defects within the product itself, and does not cover the cost of installation or removal from a fixed installation, normal set-up or adjustments, claims based on misrepresentation by the seller or performance variations resulting from installation-related circumstances.

